

# BIO ETHANOL SUITE

## Installation Guide

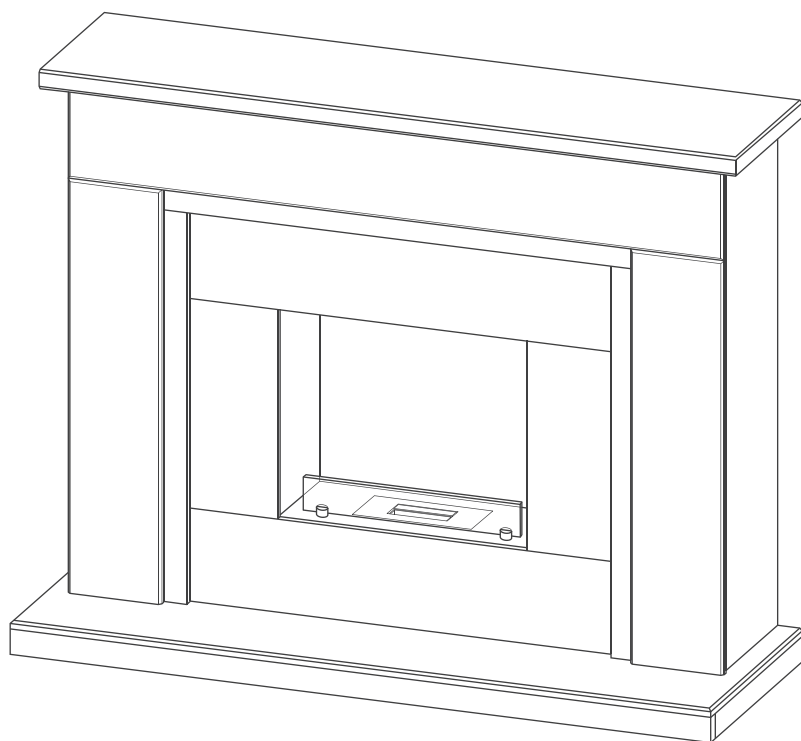

Please read through the use & care manual provided with this product first.

[www.firedupcorporation.com/manual](http://www.firedupcorporation.com/manual)

## PARTS SUPPLIED

- Hearth
- Surround
- Shelf
- Bio Ethanol Fire
- Fixing Kit

## TOOLS & PARTS REQUIRED

- Pencil/Pen
- Drill & 6mm Drill Bit
- Silicone / Caulk

## Installation

1. Place the hearth against the wall, ensuring it is level and secure.

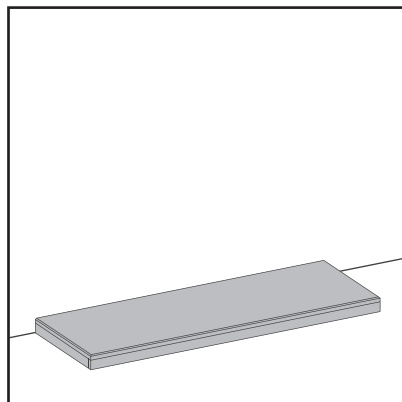

2. Fix the included neoprene strips around the frame of the Firebox and remove the non-stick layer, exposing the adhesive.

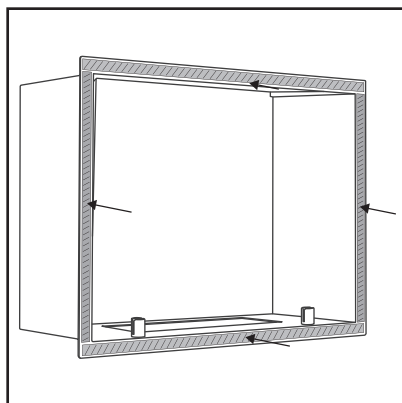

3. Fix the fire in position, central to the opening, from the rear. To secure the fire, push it firmly against the fireplace body so the neoprene strips stick.

Position the fireplace body against the wall, on the hearth and check it is central.

Note: The skirting board can be cut to accommodate the width of the fireplace body to offer a closer fit to the wall. (Measure the body and mark the skirting for the correct cut).

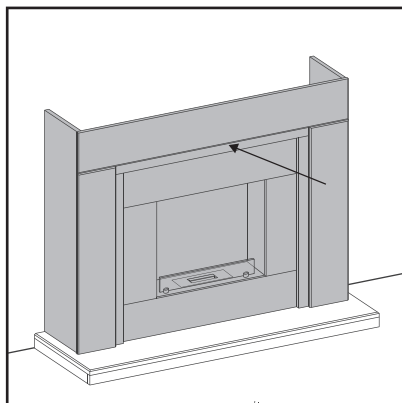

4. Once in position, fix the body to the wall using the anti-topple straps and the brackets provided.

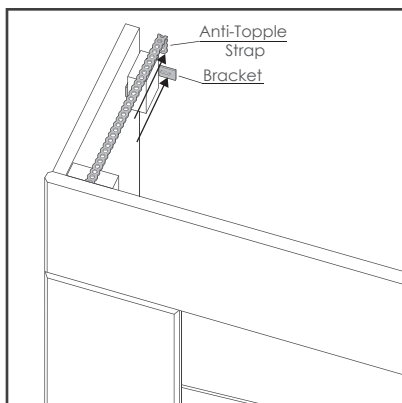

5. Once brackets are in place, apply 3 x "pea sized" dabs of silicone onto the top edge of surround and, with help, lift the shelf and slowly lower onto the surround.

Check shelf is central once lowered onto surround.

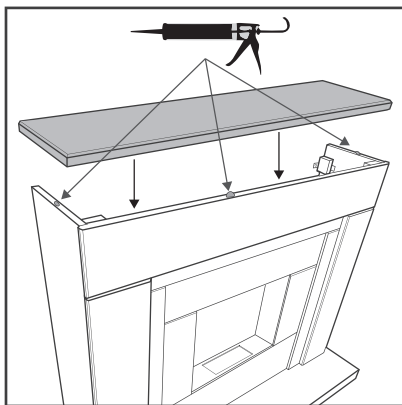

6. Lower the burner into the firebox.

**IMPORTANT:** Ensure the opening of the burner is towards the front of fireplace.

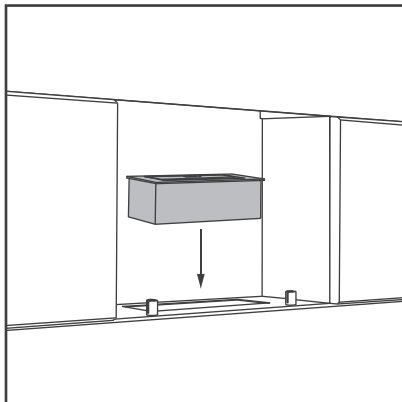

7. Sit the glass into the brackets on the fire.

